

electrical documentation



| type | rated voltage | frequency | rated power | rated current |
|-------------|---------------|-----------|-------------|---------------|
| C4e 6.10 EB | 440V 3PH | 60Hz | 9,2kW | |
| C4e 6.10 EB | 480V 3PH | 60Hz | 10,9kW | |
| | | | | |

Welbilt Deutschland GmbH

Talstraße 35
D-82436 Eglfing / Germany

+49 (0)8847 - 67 - 0

+49 (0)8847 - 67 - 414

www.convotherm.com

fuses on site!
Please look at local supply regulations!

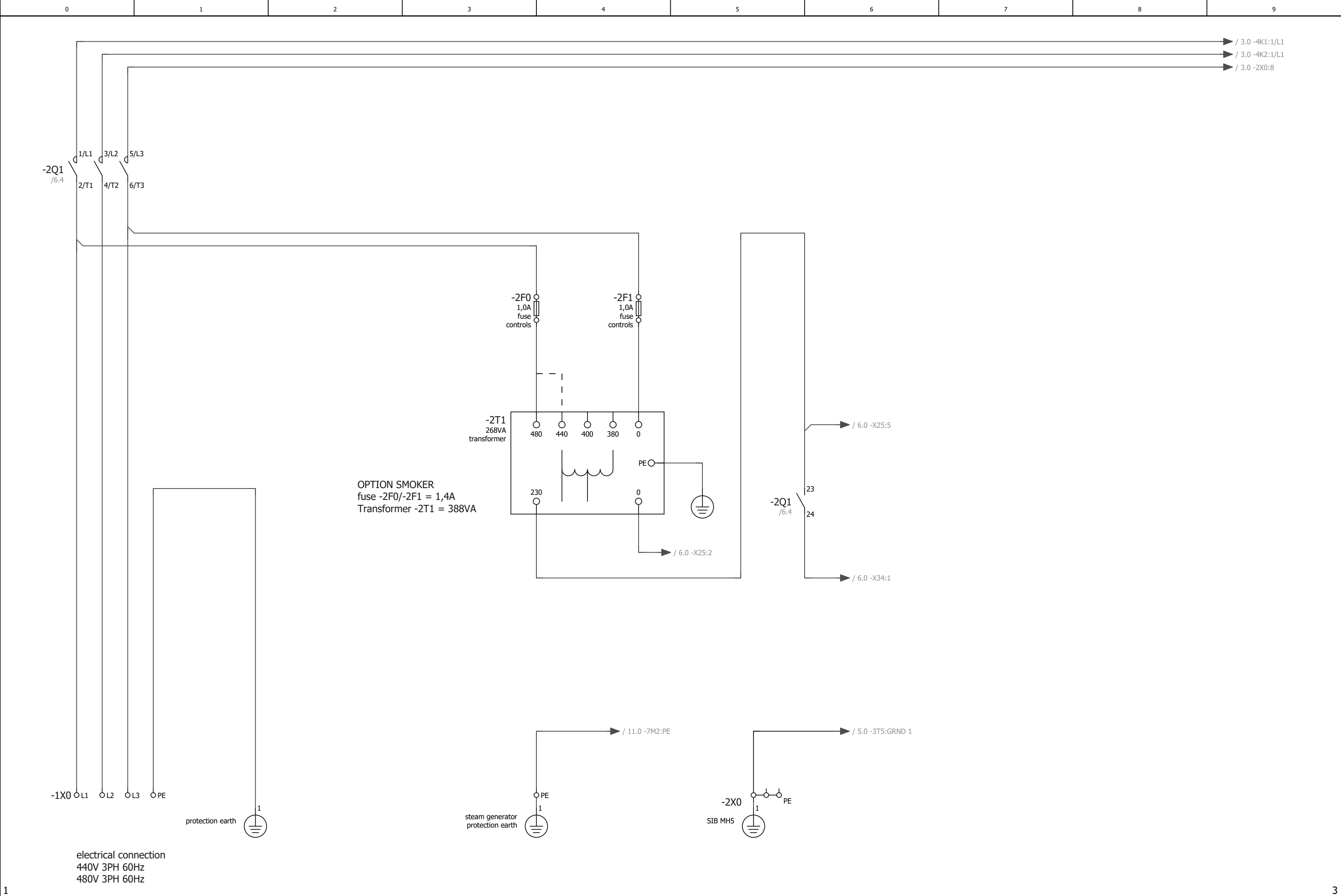

| | | | | | | | | | | | | |
|-----|------------|------------|------|-------|-----------|----------------------------|--|------------|------------------------|--|-------|--------|
| 04 | ÄM088/2017 | 28.11.2017 | SchM | Drawn | 4/19/2022 | C4e 6.10 EB C4e 6.10 EB | Welbilt Deutschland GmbH Talstraße 35 D-82436 Eglfing / Germany @2014 | convection | Project No. 5354126 | | = SLP | |
| 03 | ÄM217/2015 | 22.12.2015 | SchM | Name | Boe | | | | + MPL | | | |
| 02 | ÄM071/2015 | 20.04.2015 | SchM | App. | SchM | | | | Dr. No. 5153070 | | Blatt | 3 |
| REV | Remarks | Date | Name | Norm | | | | | | | Seite | 3 / 12 |

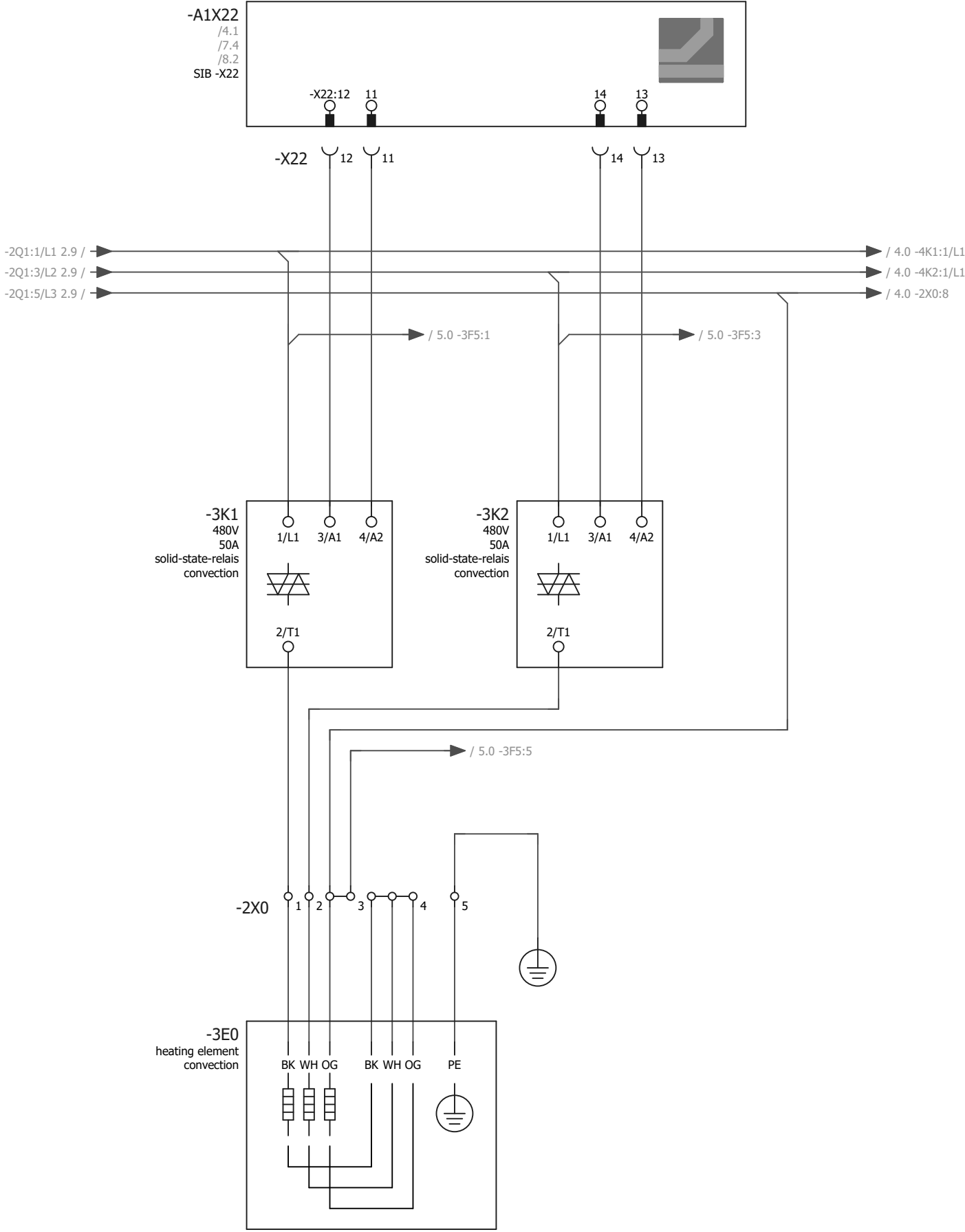

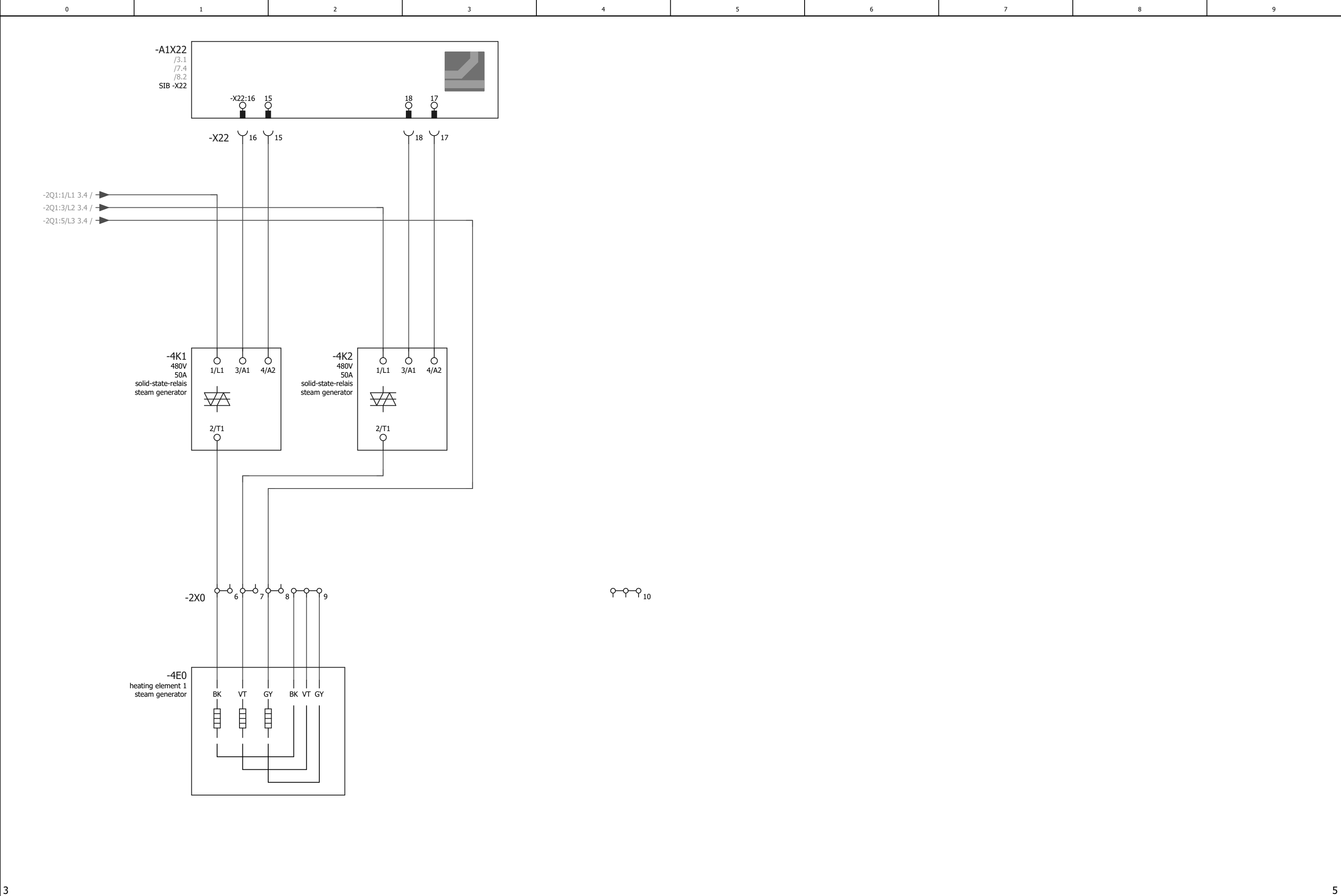

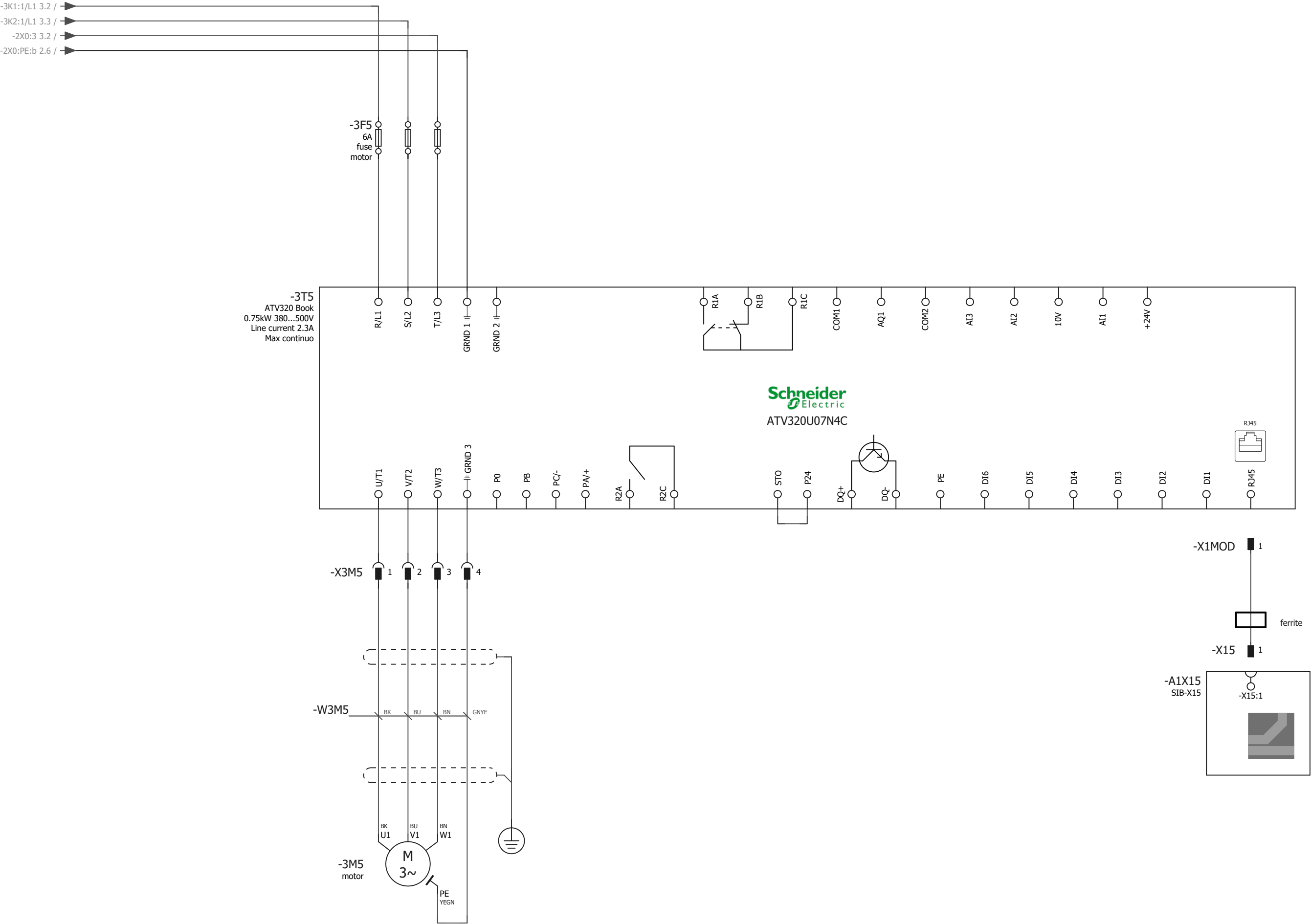

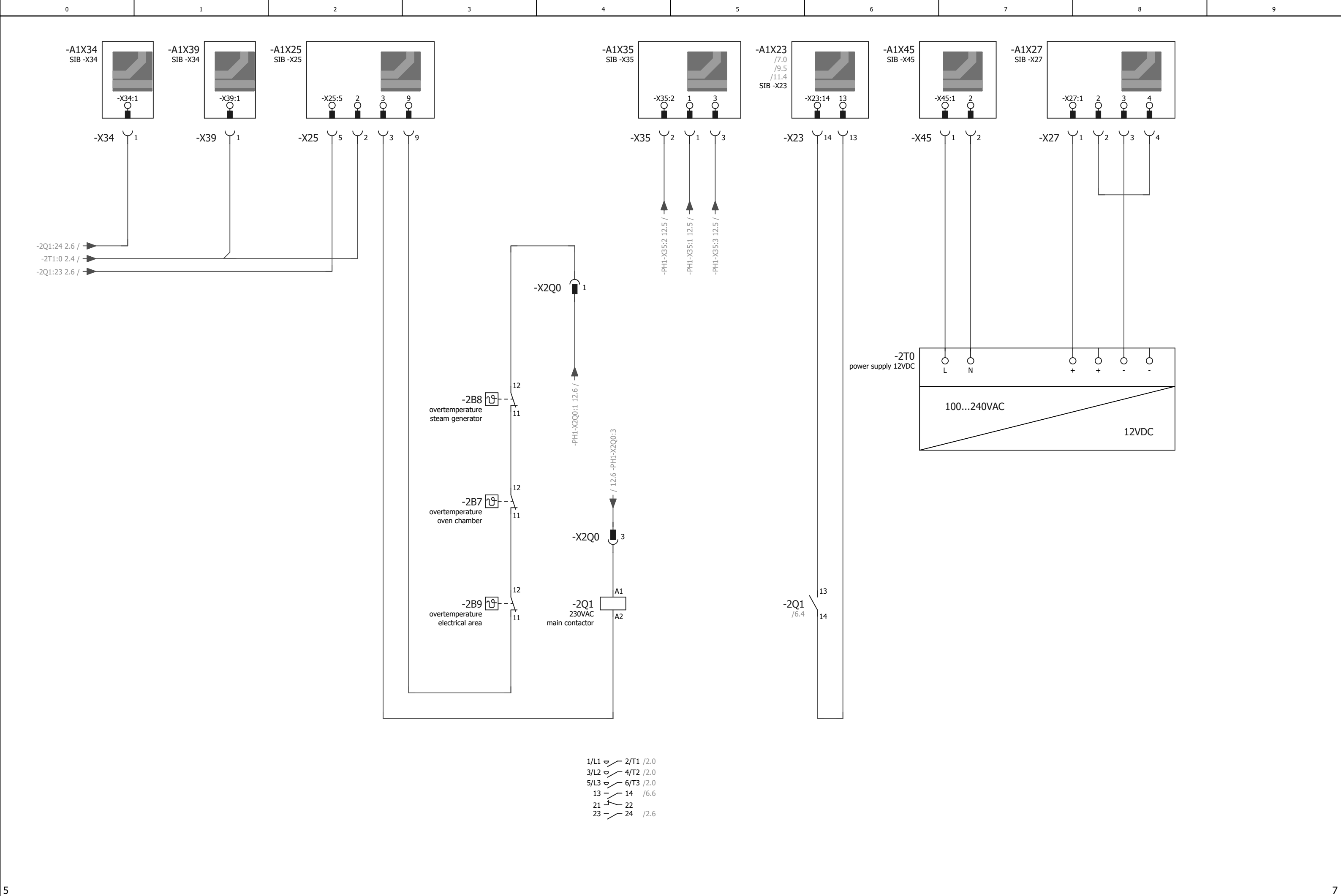

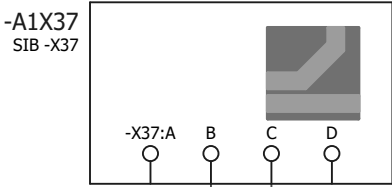
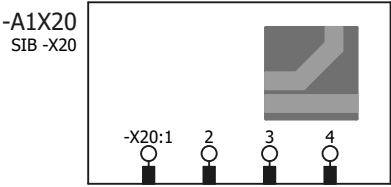
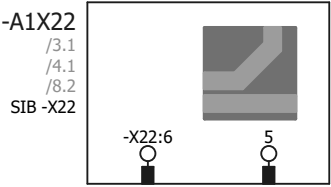
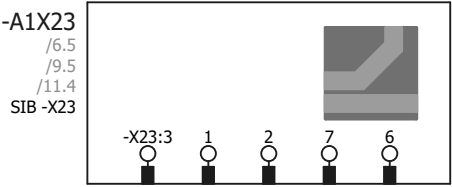

SICOTRONIC

